

# RP's information 6590731

Call out	Part Number	Description	Qty	Material
9	6590731031	CHAISE PAD	1	Fabric
12	427625RP	POLY CUSH	1	FOAM, LMF
17	427629RP	POLY BK CHAISE	1	FOAM, LMF
18	427630RP	POLY OTTO	1	FOAM, LMF
34	6590731048	COMPLETE IN/OUT BACK	1	Fabric
35	6590731042	OUTSIDE BACK	1	Fabric
43	6590731021	SEAT PLATFORM	1	Fabric
46	31781P1	ROUND PLASTIC LEG 1/P	4	Plastic
76	6590758337	SMALL OTTOMAN/FOOTREST UPHOL	1	Fabric
80	6590731341	OUTSIDE BACK SKIRT FLAP	2	Fabric
102	11PWR3368MK-1RP	-11 PWR 3368 KAIDI V2 MECH	1	Metal
145	31442RP	3368 KAIDI MOTOR	1	Plastic, Metal
148	30383RP	POWER SUPPLY KIT W/DC CBL-1ST	1	Plastic, Metal
149	76796RP	KD BRACKET AND CLIP ASSEMBLY	2	Metal
165	32055RP3	P2/P3 HEADREST MOTOR PLASTIC MTR SHAFT	1	Plastic, Metal
173	32054RP1	P2 (THR) MECH -14 PLASTIC MTR SHAFT	1	Metal
225	31035RP	CENTER SEAT BUTTON LSF	1	Plastic, Metal
227	31071RP	IND HX WSHRHD ST #10-12X3/4	2	Metal
357	30651RP	FIBER RECYCLED BROWN	5	Fiber
393	30908RP	CHANNEL EDGE ¼ X 7 CLEAR	2	Plastic



# RPs' information 6590731

Call out	Part Number	Description	Qty	Material
400	74843RP	FURNITURE CONNECTOR	4	Metal
419	74018RP	HDWE 1/4-20X.75 WSHRHD5/16	8	Metal
426	77075RP	1-4-20X3/4 HX HD ZINC PRECT80	4	Metal
499	73507RP	BOLT 1/4-20X3/4 INCH	8	Metal
653	31865RP	POWER MOTION TESTER CABLE	1	Plastic, Metal
654	32051RP	POWER MOTION TESTER LIGHT	1	Plastic, Metal

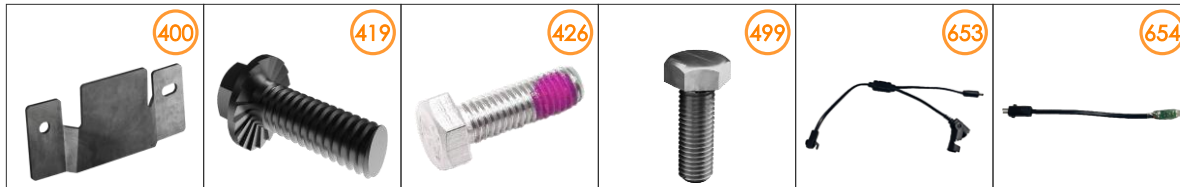

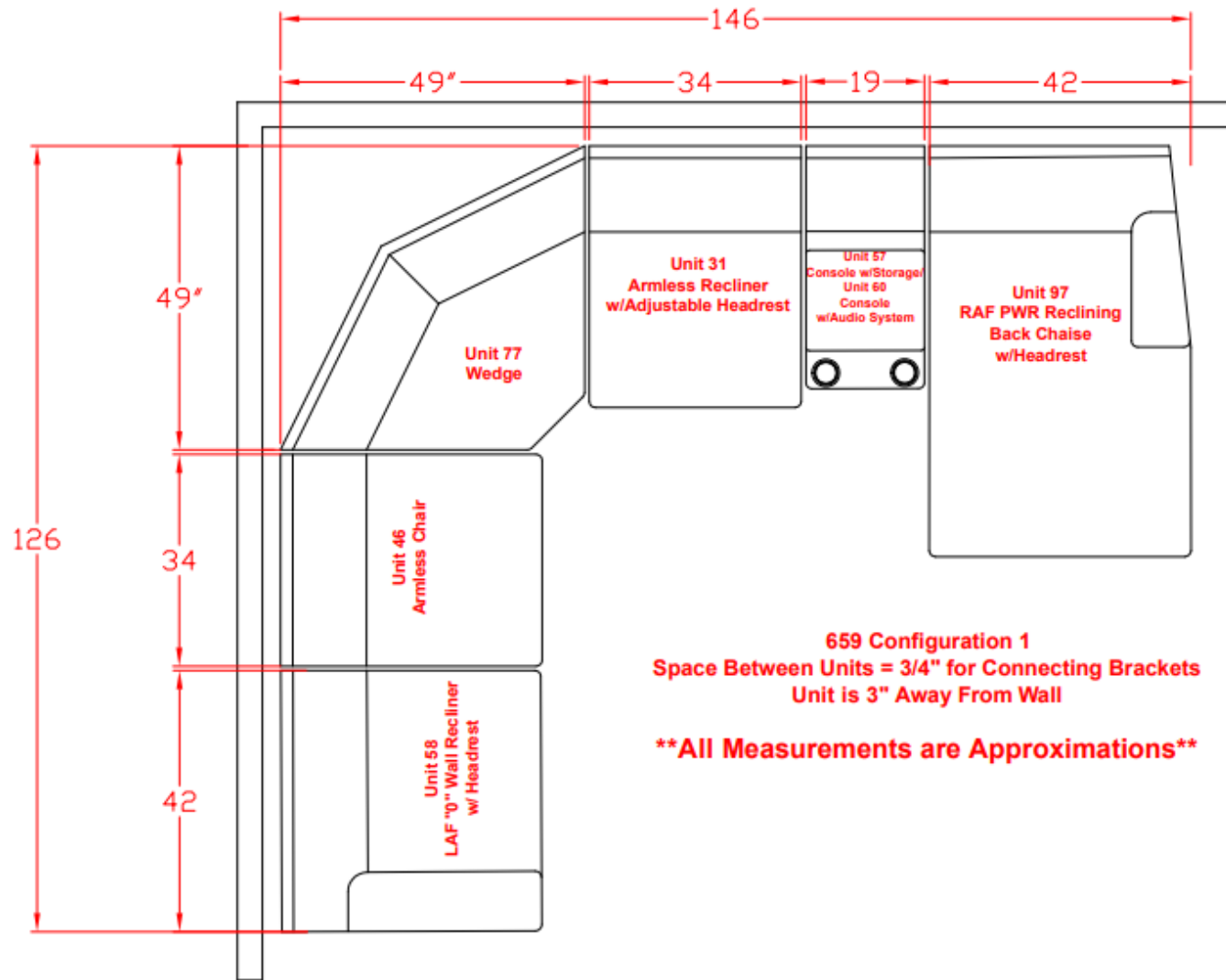

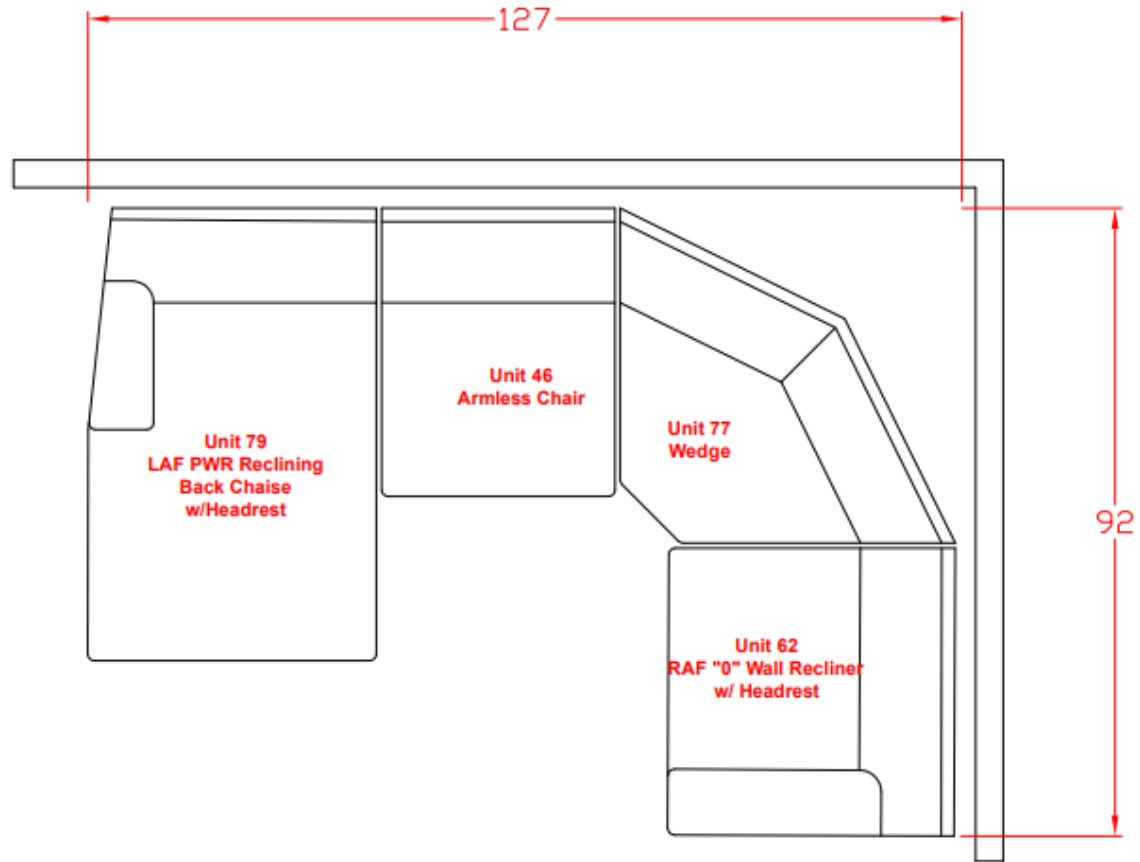

**659 Configuration 2**  
**Space Between Units = 3/4" for Connecting Brackets**  
**Unit is 3" Away From Wall**

**\*\*All Measurements are Approximations\*\***

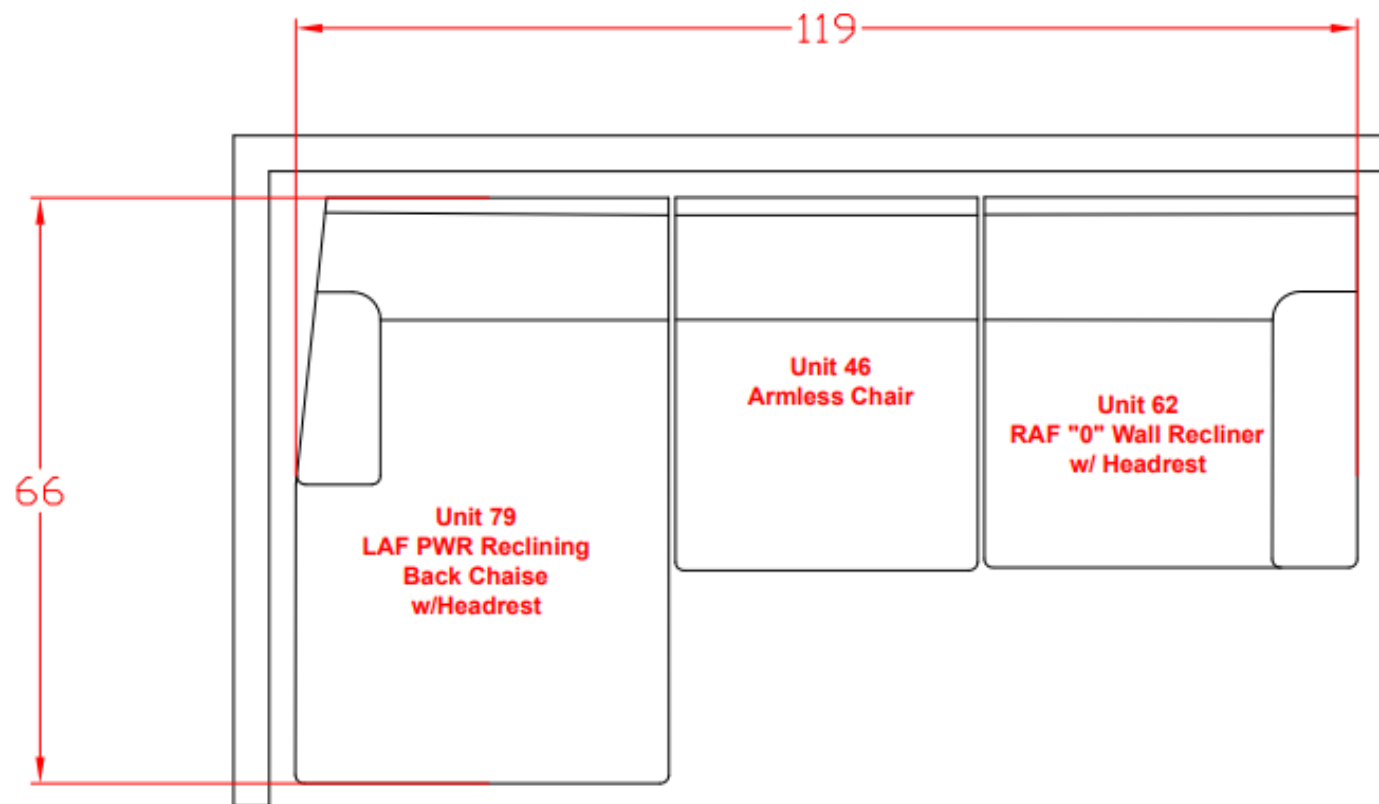

**659 Configuration 3**  
**Space Between Units = 3/4" for Connecting Brackets**  
**Unit is 3" Away From Wall**

**\*\*All Measurements are Approximations\*\***

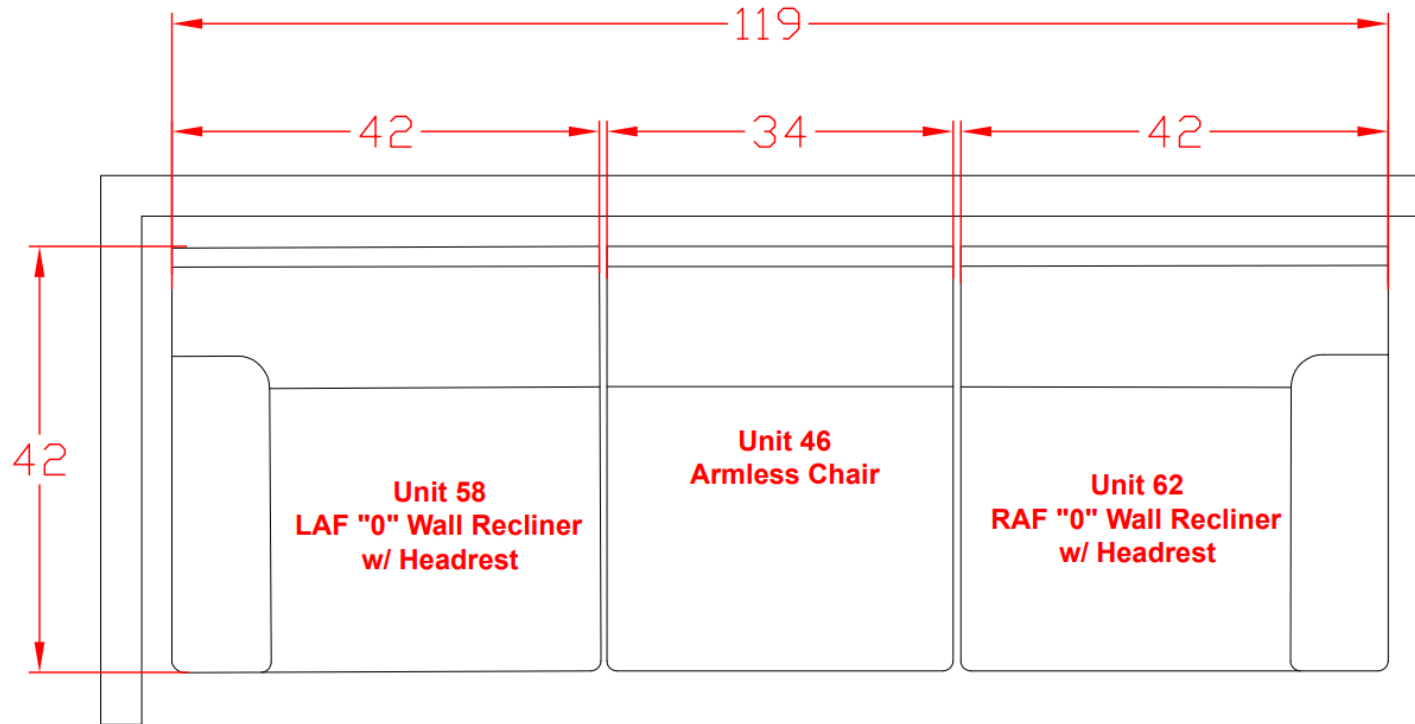

**659 Configuration 4**  
**Space Between Units = 3/4" for Connecting Brackets**  
**Unit is 3" Away From Wall**

**\*\*All Measurements are Approximations\*\***